

HS

Project:

**38 Orlando St. Hampton
Melbourne, Vic.**

FINISHES SCHEDULE

ID	SPECIFICATION	IMAGE	SUPPLIER
CF1	Timber Veneer [to match TV unit / study joinery]	N/A	Joiner

Joiner to quote for more cost effective alternative to CF1.
Review with client.

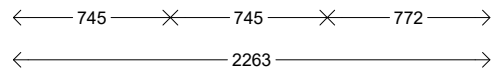
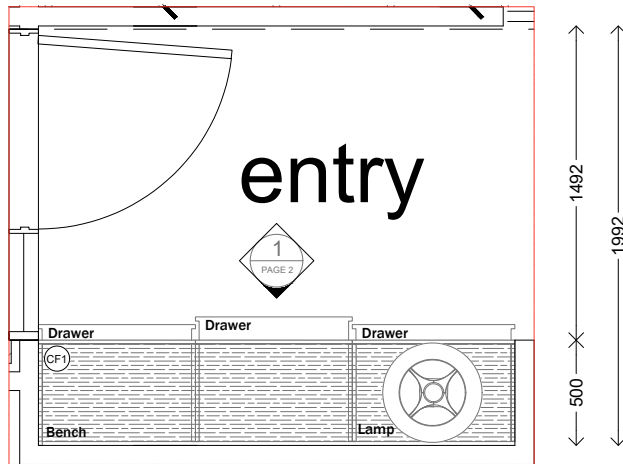

Detail plan
Entry
Scale 1:50

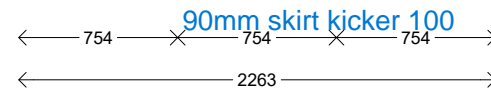
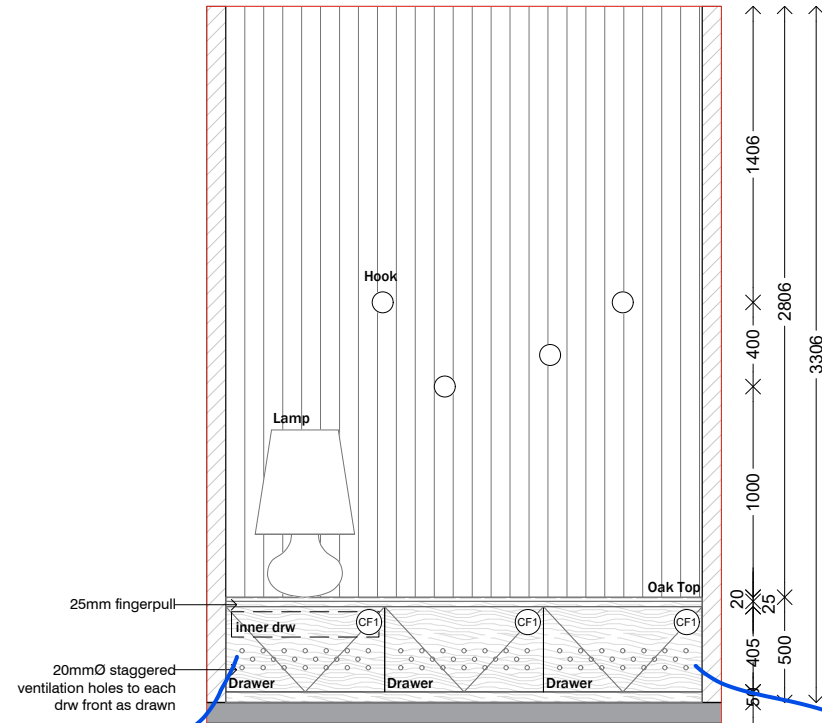

Elevation 1
Entry
Scale 1:50

16mm thick skirt

30mm filler

30mm filler

HS

Project:
**38 ORLANDO ST HAMPTON
MELBOURNE, VIC.**

Project:
NN

Client approval:

Page #: **1/5** Revision: **6** Scale: **1:50** Draw: **JAA** Date: **31/08/21**

Drawing:
GROUND FLOOR / ENTRY / JOINERY

Notes:

- | No: | Revision notes: | Date: | Initials: |
|-----|---|-------|-----------|
| 1. | All dimensions are to be checked on-site and any discrepancies brought to the attention of Homeroom Studio prior to construction. When a dimension is not clear it is the builder's responsibility to clarify the dimension with the architect. It is the builder's responsibility to cross reference working drawings with authority endorsed documents. | | |
| 2. | | | |
| 3. | This design is dependant on approval by relevant authorities and comparison with client budget requirements. At the time of design confirmation of these approvals has not been confirmed. | | |
| 4. | | | |
| 5. | These drawings are not to be scaled. | | |
| 6. | This design and accompanying documentation is and remains the exclusive property of the client until a written release is signed. Design is schematic only and subject to council and other requisite approvals. | | |

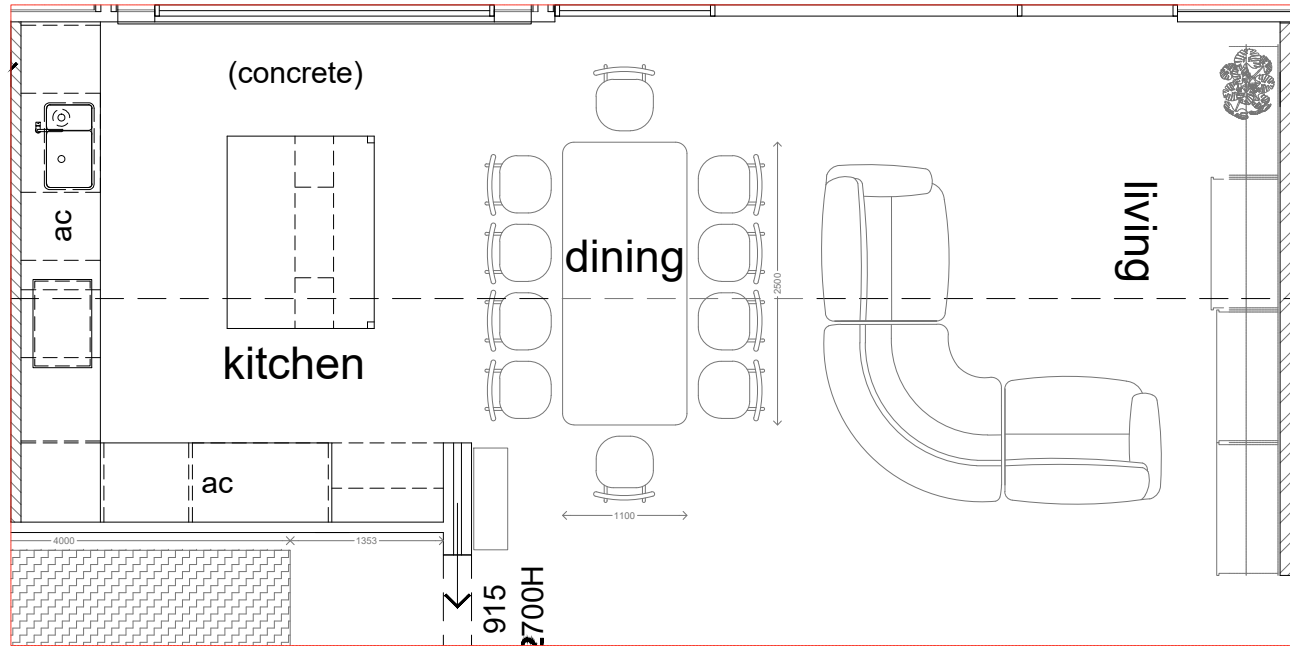

Detail plan
Dining

Scale 1:25

HS	Project: 38 ORLANDO ST HAMPTON MELBOURNE, VIC.				Drawing: GROUND FLOOR / DINING / JOINERY		No: 1. 2. 3. 4. 5. 6.	Revision notes: <small>All dimensions are to be checked on-site and any discrepancies brought to the attention of Homeroom Studio prior to construction. When a dimension is not clear it is the builder's responsibility to clarify the dimension with the architect. It is the builder's responsibility to cross reference working drawings with authority endorsed documents.</small> <small>This design is dependant on approval by relevant authorities and comparison with client budget requirements. At the time of design confirmation of these approvals has not been confirmed.</small> <small>These drawings are not to be scaled.</small> <small>This design and accompanying documentation is and remains the exclusive property of the client until a written release is signed. Design is schematic only and subject to council and other requisite approvals.</small>	Date:	Initials:
	Project: NN				Notes:					
	Page #: 2/5	Revision: 3	Scale: 1:50	Draw: JAA	Date: 31/08/21	Client approval:				

Note: Client to organize GPO relocation noting wall insulation must be kept intact.
 Additional power sto be provisioned around the joinery for powering phone and a extra lamp .

Cabinet maker to allow for Addition cut outs for GPO's to be discussed on site with client

FINISHES SCHEDULE			
ID	SPECIFICATION	IMAGE	SUPPLIER
CF2	Dulux Tiemo 2Pac Paint Matt Colour Code S26A3		Joiner
FT2	Curve Pull White Small - 200mm		Lo&Co

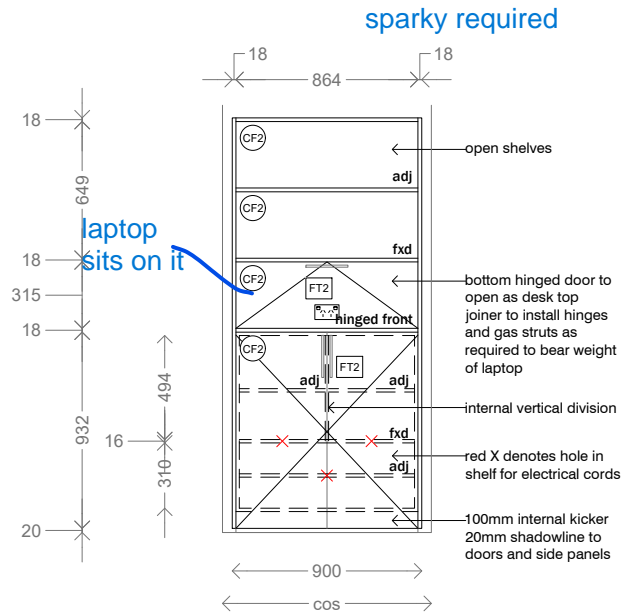

 **Elevation 1**
Dining

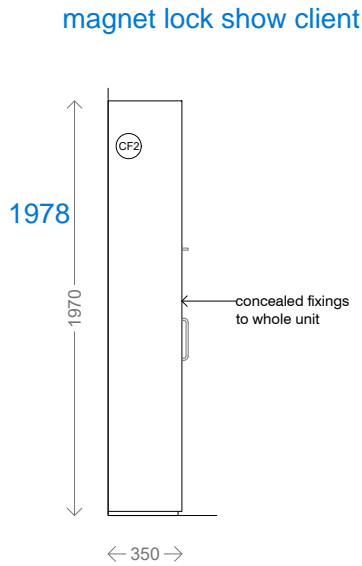

 **Elevation 2**
Dining

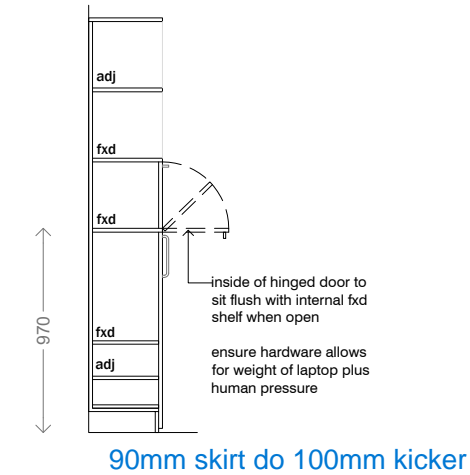

 **Section 1**
Dining

HS

Project: 38 ORLANDO ST HAMPTON MELBOURNE, VIC.				
Project: NN				
Client approval:				
Page #: 3/5	Revision: 3	Scale: 1:50	Draw: AS	Date: 29/05/23

Drawing: GROUND FLOOR / DINING / JOINERY
Notes:

No:	Revision notes:	Date:	Initials:
1.	All dimensions are to be checked on-site and any discrepancies brought to the attention of Homeroom Studio prior to construction. When a dimension is not clear it is the builder's responsibility to clarify the dimension with the architect. It is the builder's responsibility to cross reference working drawings with authority endorsed documents.		
2.			
3.	This design is dependant on approval by relevant authorities and comparison with client budget requirements. At the time of design confirmation of these approvals has not been confirmed.		
4.			
5.	These drawings are not to be scaled.		
6.	This design and accompanying documentation is and remains the exclusive property of the client until a written release is signed. Design is schematic only and subject to council and other requisite approvals.		

FINISHES SCHEDULE			
ID	SPECIFICATION	IMAGE	SUPPLIER
CF3	Polytec Classic White Matt Suitable for desktop use (joiner to confirm)		Joiner
CF4	Whiteboard & magnetic finish - TBC by joiner & pending client approval	N/A	Joiner

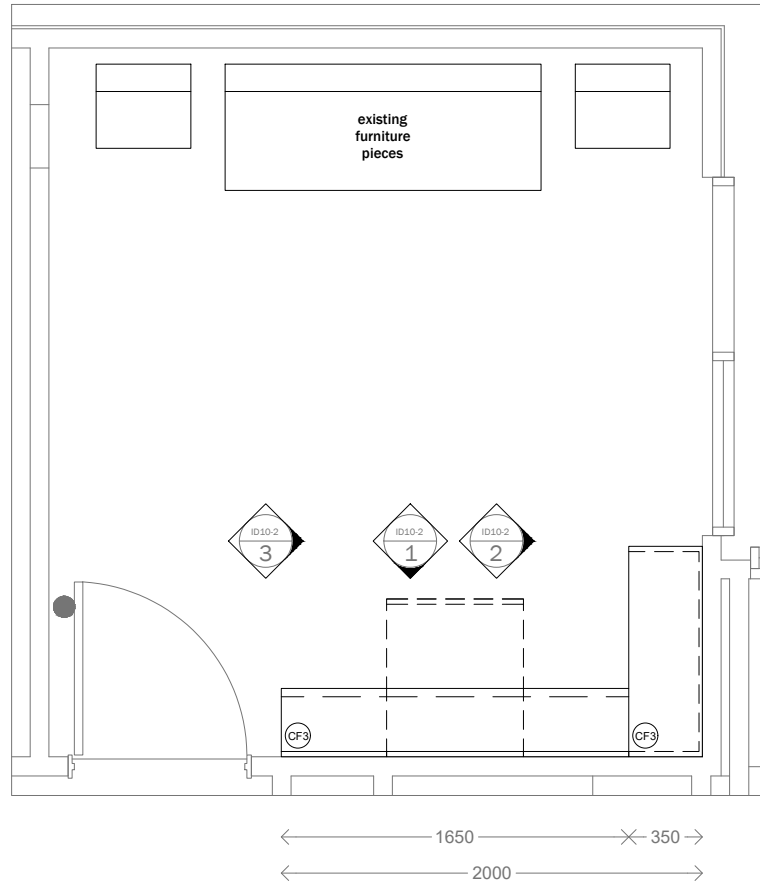

Detail Plan
Zen Room

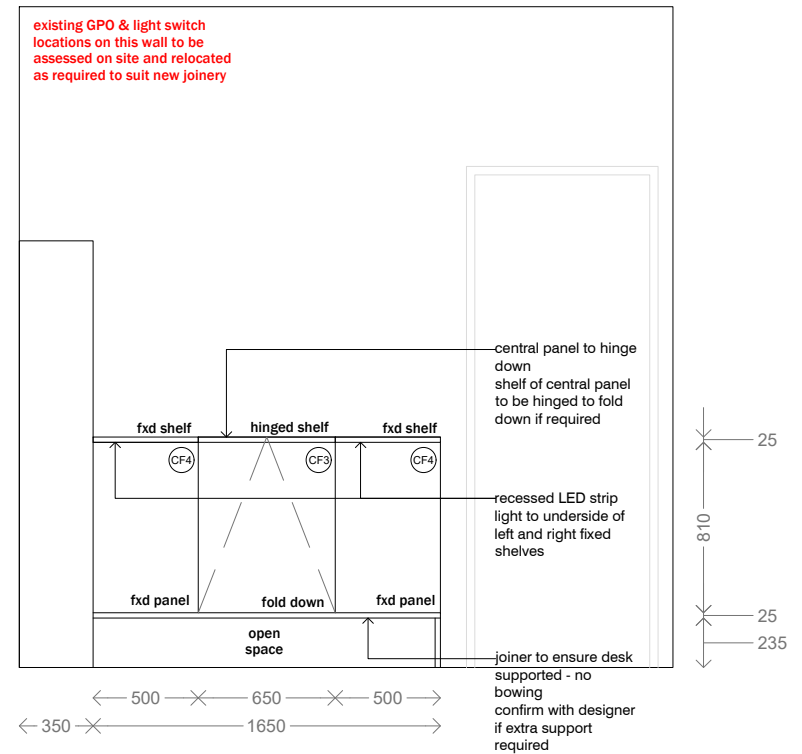

Elevation 1
Zen Room

HS

Project:
**38 ORLANDO ST HAMPTON
MELBOURNE, VIC.**

Project:
NN

Client approval:

Page #:
4/5

Revision:
3

Scale:
1:50

Draw:
AS

Date:
29/05/23

Drawing:
GROUND FLOOR / ZEN ROOM / JOINERY

Notes:

No:

- 1.
- 2.
- 3.
- 4.
- 5.
- 6.

Revision notes:

All dimensions are to be checked on-site and any discrepancies brought to the attention of Homeroom Studio prior to construction. Where a dimension is not clear it is the builder's responsibility to clarify the dimension with the architect. It is the builder's responsibility to cross reference working drawings with authority endorsed documents.

This design is dependant on approval by relevant authorities and comparison with client budget requirements. At the time of design confirmation of these approvals has not been confirmed.

These drawings are not to be scaled.

This design and accompanying documentation is and remains the exclusive property of the client until a written release is signed. Design is schematic only and subject to council and other requisite approvals.

Date:

Initials:

FINISHES SCHEDULE

ID	SPECIFICATION	IMAGE	SUPPLIER
CF3	Polytec Classic White Matt Suitable for desktop use (joiner to confirm)		Joiner
CF4	Whiteboard & magnetic finish - TBC by joiner & pending client approval	N/A	Joiner

Note: Client to organize GPO relocation noting wall insulation must be kept intact. Additional power to be provisioned around the joinery for powering phone and a extra lamp .
Cabinet maker to allow for Addition cut outs for GPO's to be dicussed on site with client

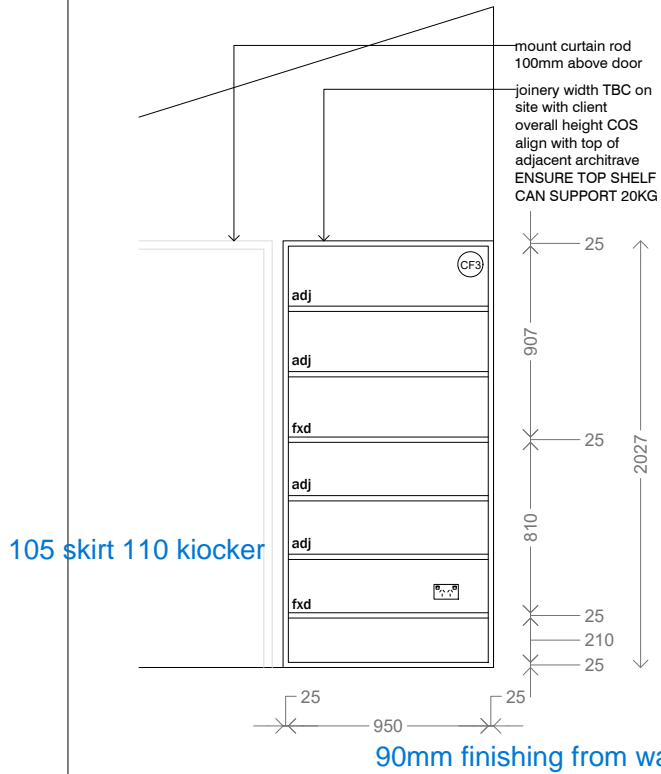

Elevation 2
Zen Room

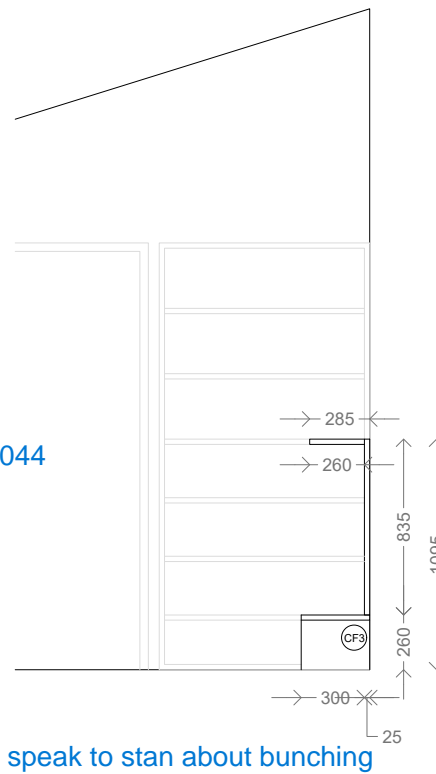

Elevation 3a
Zen Room

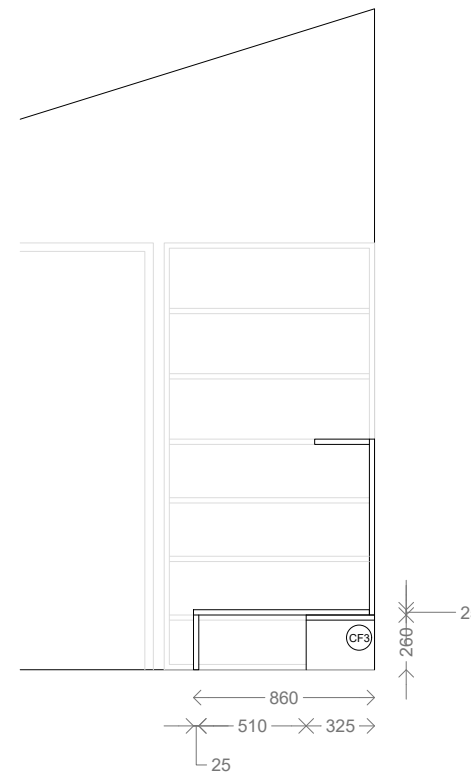

Elevation 3b
Zen Room

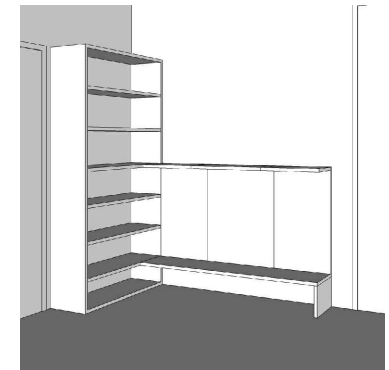

Panel Up
Zen Room

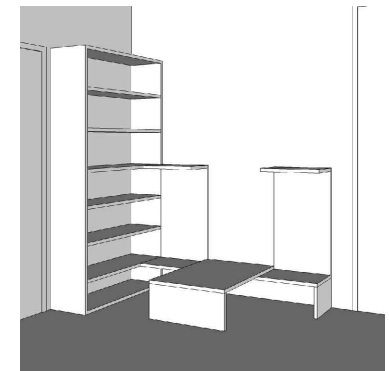

Panel Down
Zen Room

HS

Project:
**38 ORLANDO ST HAMPTON
MELBOURNE, VIC.**

Project:
NN

Client approval:

Page #: **5/5**

Revision: **3**

Scale: **1:50**

Draw: **AS**

Date: **29/05/23**

Drawing:
GROUND FLOOR / ZEN ROOM / JOINERY

Notes:

No:

- 1.
- 2.
- 3.
- 4.
- 5.
- 6.

Revision notes:

1. All dimensions are to be checked on-site and any discrepancies brought to the attention of Homeroom Studio prior to construction. When a dimension is not clear it is the builder's responsibility to clarify the dimension with the architect. It is the builder's responsibility to cross reference working drawings with authority endorsed documents.
- 2.
3. This design is dependant on approval by relevant authorities and comparison with client budget requirements. At the time of design confirmation of these approvals has not been confirmed.
4. These drawings are not to be scaled.
- 5.
6. This design and accompanying documentation is and remains the exclusive property of the client until a written release is signed. Design is schematic only and subject to council and other requisite approvals.

Date:

Initials: