

OVERHEADS  
323mm DEEP

JF01 JOINERY FRONTS +  
PANELS : Polytec Ligurian  
Walnut Woodmatt 16mm

JF02 CARCASS :  
Matt white melamine

HANDLES :  
Re-use existing on site

HARDWARE :  
Soft close hinges + runners

existing cupboards, fillers  
panels and shadow lines  
to remain

new fixed panel + cupboard  
underpanel to cupboard  
re-use handle from base  
cabinet hamper  
centre handle on door and  
align with adjacent  
cupboard handles

benchtop + splashback  
to remain

sink cabinet carcass to remain [all other  
base joinery to be removed + replaced  
including kickers and filler panels]  
re-use sink cabinet handle and install on  
new door

new hamper drawer  
drawer carcass to be melamine  
with high internal sides as drawn  
re-use handle from old drawer unit  
centre handle on drawer front  
and align with sink cabinet handle

BASE CABINETS  
600mm DEEP

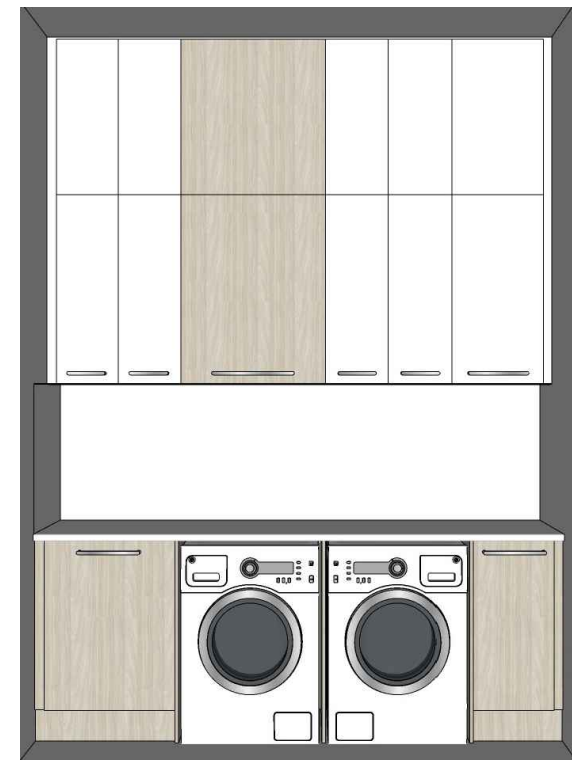

new joinery to this area  
existing panels + wall  
cleats to be removed  
by TIP



all base cupboard  
handles to be retained  
for re-use

LAUNDRY ELEVATION - PROPOSED

1:20 @ A3

LAUNDRY ELEVATION - EXISTING

1:20 @ A3