

NOTE:

- 3x Sliding Doors Required
- * Cut 3 MDF Satin Paint Grade 18mm
3 of 2071x1287
- Track used TITUS TEKFORM 610.9691.380.K4
- All vertical panels and Shelves need to be 83mm shorter than top & Bottom panels.
- Side Fillers need to have a 150mm return panel due to the -83mm sides

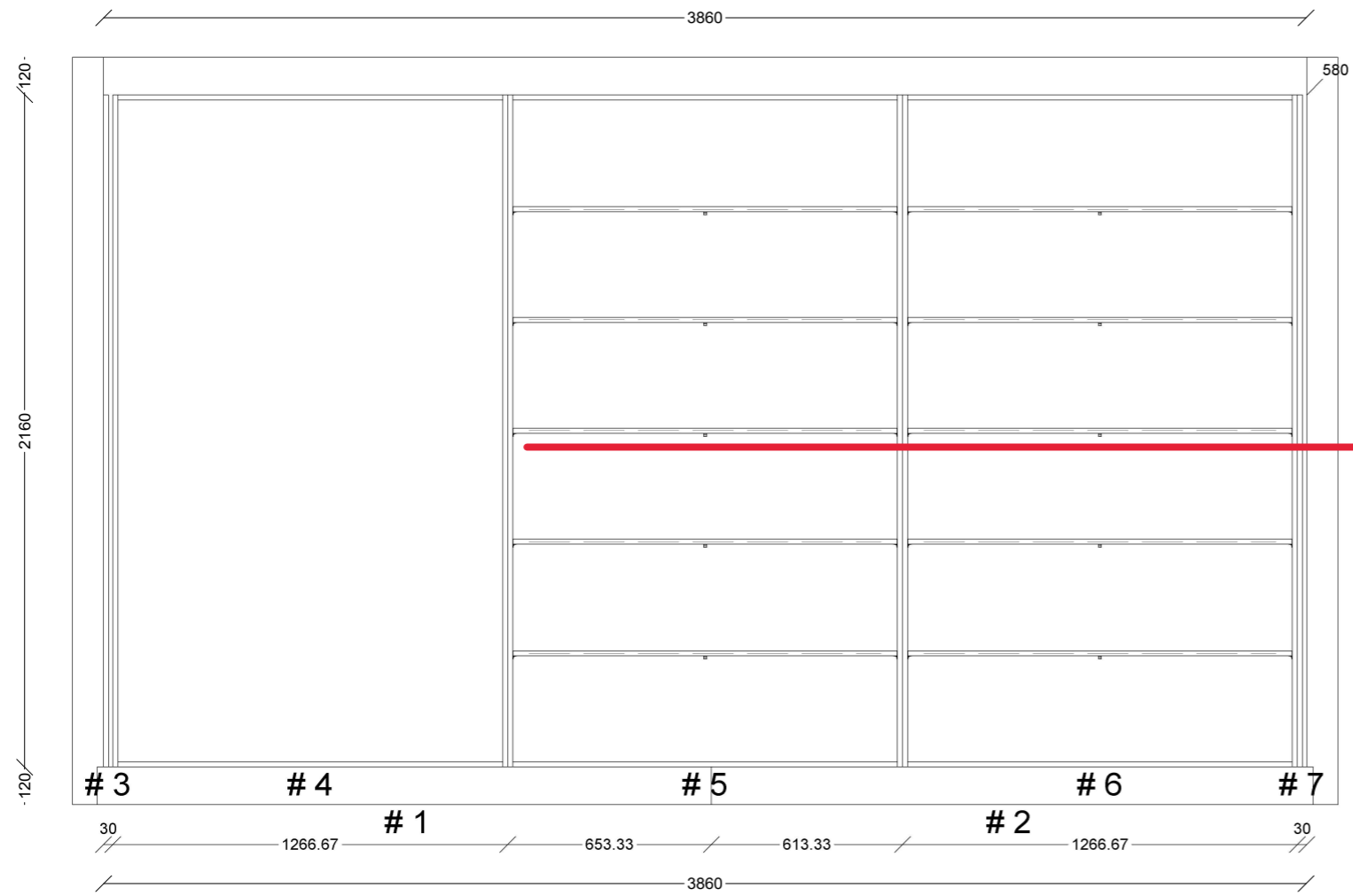

* Split tall cabinet internally

DAVICON Group
 admin@davicongroup.com
 Phone: 0433 261 558



Approved

Rejected (As Noted)

Name:		Title: Default	
Address:		Scale:	Date:
City:	State:	DWG. By:	Sheet #
Job #: Hayley Lexington st		LEX Rumpus	

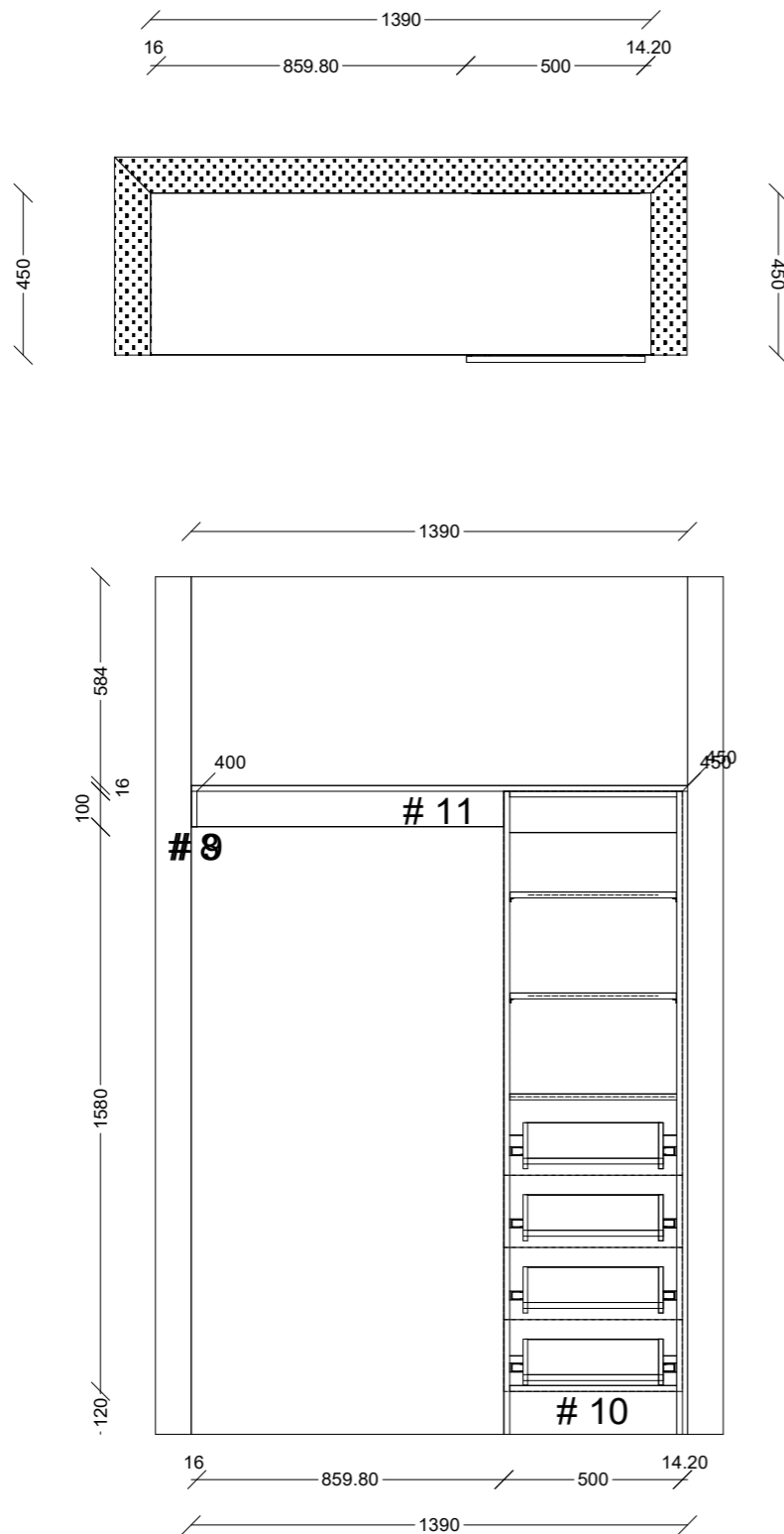

NOTE:

- Please cut 2 Sliding doors in 18mm MDF Satin Paint grade

* 2 of 2203x610

Track Used TITUS TEKFORM 610.9691.380.K3

ALSO

- Cab #10 is designed by me so please check my work.
- * All parts are camed.
- The 3 Back panel stretchers & 2 Toe Skins have not been camed. Im not sure how to do it, please fix.

DAVICON Group
 admin@davicongroup.com
 Phone: 0433 261 558



Approved

Rejected (As Noted)

Name:		Title: Default	
Address:		Scale:	Date:
City:	State:	DWG. By:	Sheet #
Job #: Hayley Lexington st			LEX Bed 3

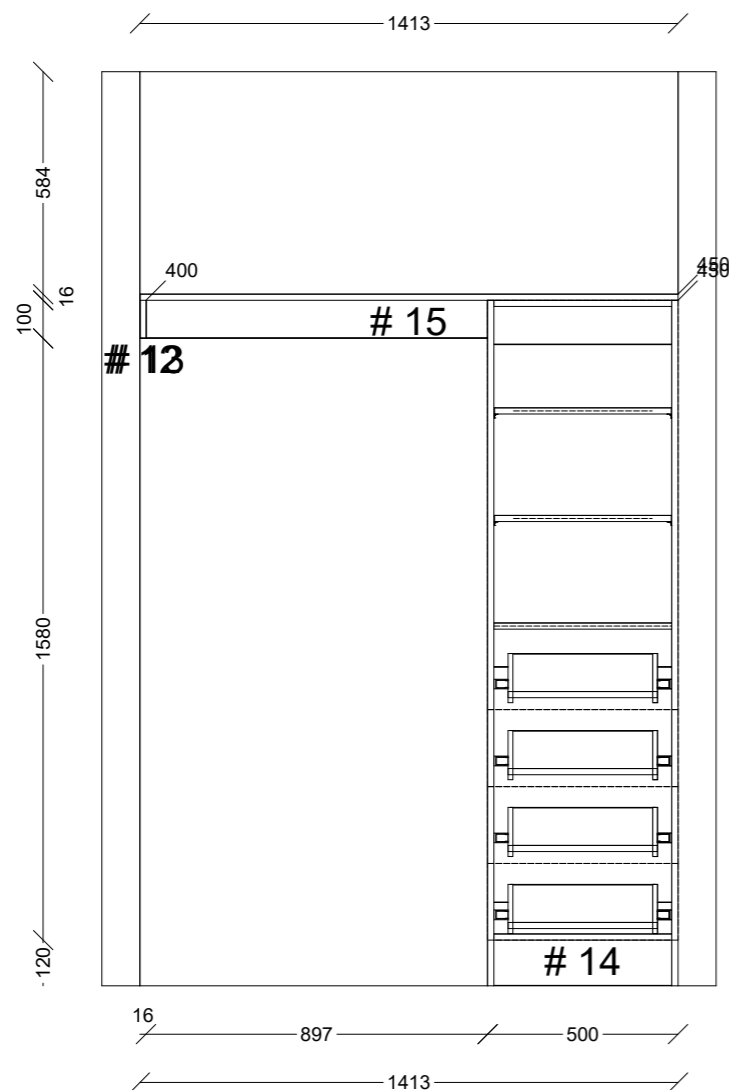
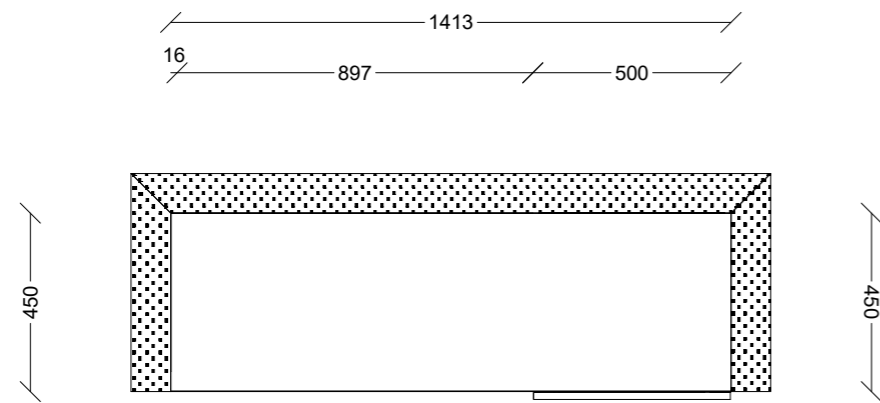

NOTE:

- Please cut 2 Sliding doors in 18mm MDF Satin Paint grade

* 2 of 2203x555

Track Used TITUS TEKFORM 610.9691.380.K3

ALSO

- Cab #10 is designed by me so please check my work.

* All parts are camed.

- The 3 Back panel stretchers & 2 Toe Skins have not been camed. Im not sure how to do it, please fix.



Approved

Rejected (As Noted)

Name:		Title: Default	
Address:		Scale:	Date:
City:	State:	DWG. By:	Sheet #
Job #: Hayley Lexington st			LEX Bed 4

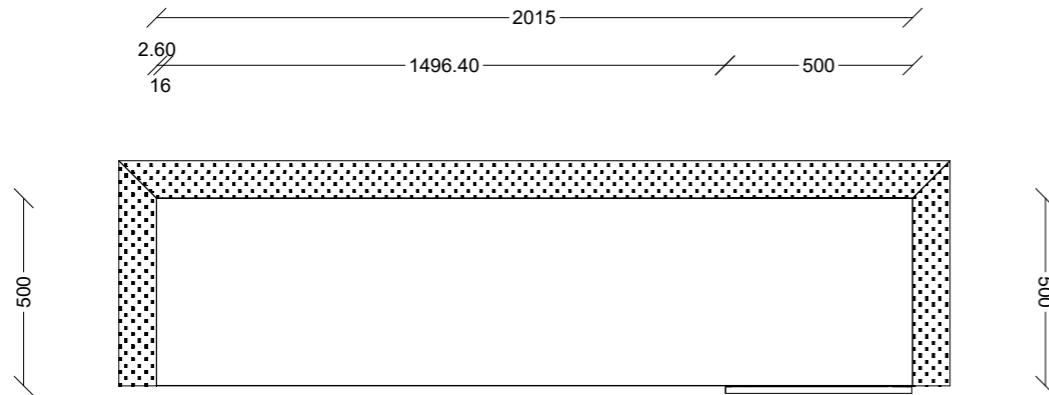

NOTE:

- Cab #18 is designed by me so please check my work.
- * All parts are came.
- The 3 Back panel stretchers & 2 Toe Skins have not been came. Im not sure how to do it, please fix.

* No Sliding door required on this one.

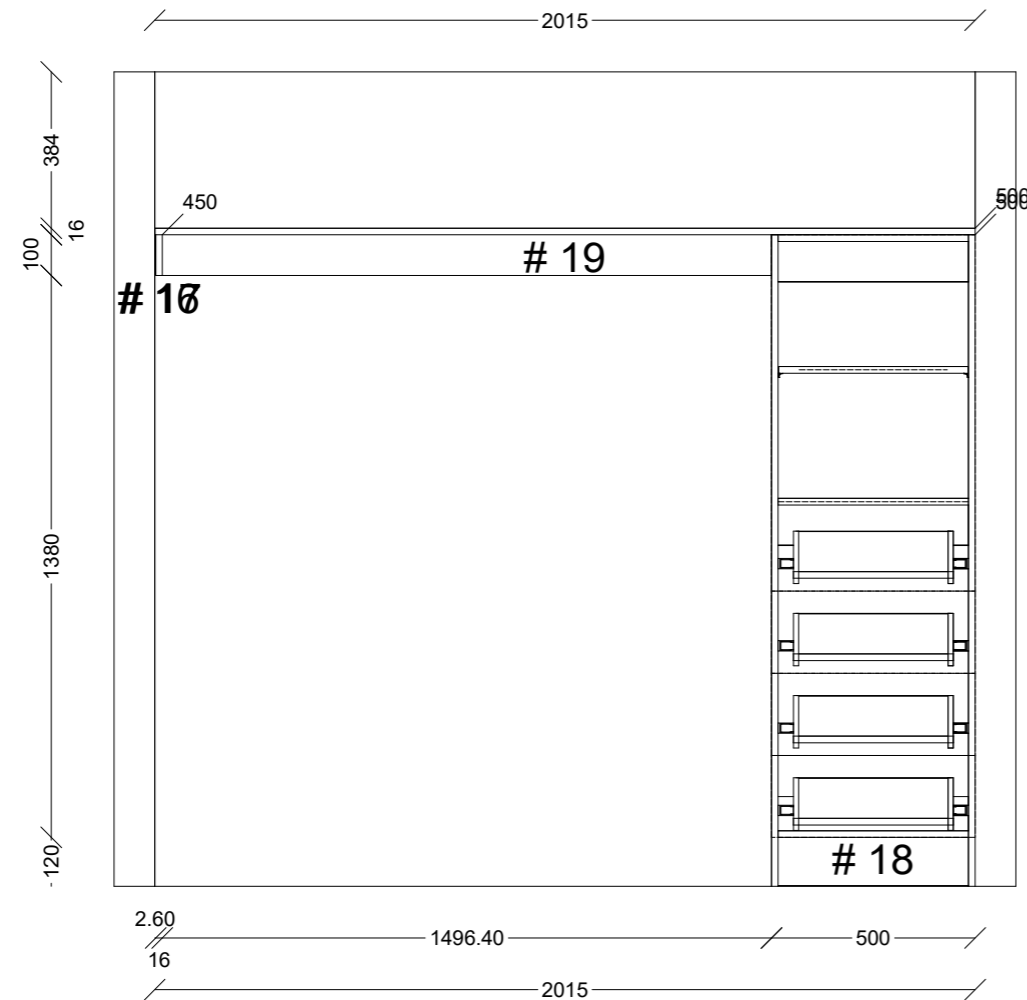

Approved

Rejected (As Noted)

Name:		Title: Default	
Address:		Scale:	Date:
City:	State:	DWG. By:	Sheet #
Job #: Hayley Lexington st		Burnley ROBE	

DAVICON Group
admin@davicongroup.com
Phone: 0433 261 558



Approved

Rejected (As Noted)

Name:		Title: Default	
Address:		Scale:	Date:
City:	State:	DWG. By:	Sheet #
Job #: Hayley Lexington st		Doors & Parts ORDER	