

GENERAL NOTES:

- ALL LEVELS SHALL BE AS PER ARCHITECTURAL DWGS AND SHALL BE CONFIRMED ON SITE.
- DOWNPIPES TO BE CONNECTED TO STORMWATER SYSTEM WITH Ø90 UPVC PIPE UN.O.
- REFER TO ARCHITECTURAL DRAWINGS FOR FINAL DOWNPIPE LOCATIONS.

DRAINAGE WORKS SHOULD BEGIN WITH CONSTRUCTION OF THE LPOD CONNECTION POINT TO ENSURE THAT THE DRAINAGE SYSTEM CAN BE BUILT AS PER THE APPROVED PLANS.

BACKFILL NOTE - PROVIDE STABILISED CLASS 2 BACKFILLED CRUSHED ROCK TO BOTH SIDES OF ALL PIPES UNDER PAVEMENT WHERE COVER IS LESS THAN 450mm.

TREE NOTE - ANY DRAINAGE EXCAVATION TO BE DUG BY HAND HELD SHOVEL UNDER THE CANOPY OF ANY EXISTING TREES TO BE RETAINED. TREE ROOTS > 30mm DIAMETER MUST NOT BE SEVERED.

GROUNDWATER NOTE - SUBSURFACE DRAINAGE SHALL BE COLLECTED IN AG PIPES AND DRAINED INTO THE DRAINAGE SYSTEM. REFER STRUCTURAL DOCUMENTATION FOR FOOTING DETAILS.

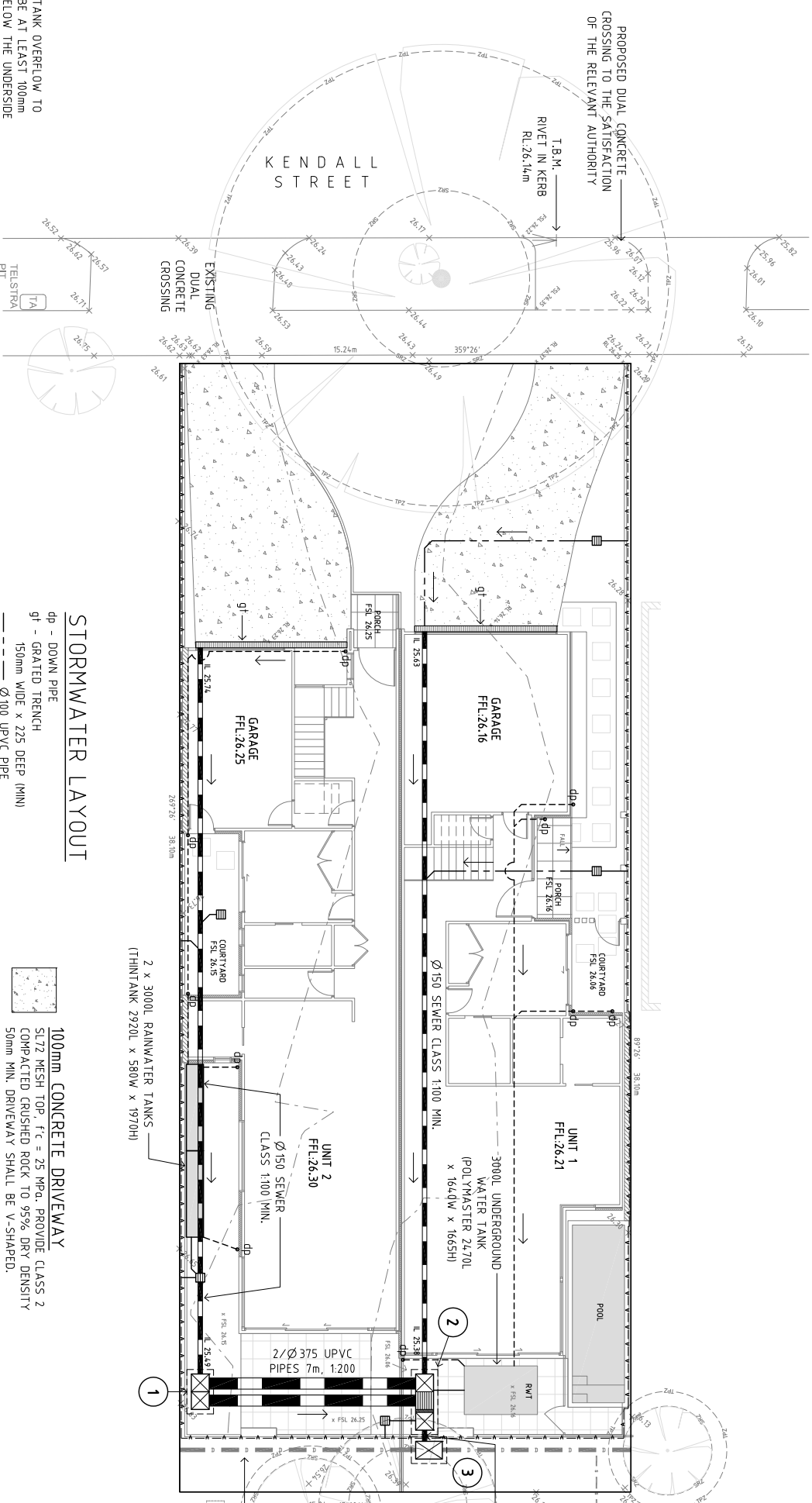

ALL UNDERGROUND SERVICES MUST BE LOCATED ON SITE BY THE CONTRACTOR PRIOR TO CONSTRUCTION. ALL WORKS IN THE VICINITY OF SERVICES MUST MAINTAIN MINIMUM CLEARANCES TO THE SATISFACTION OF THE RESPONSIBLE AUTHORITY/ASSET OWNERS. AN INVESTIGATION TO LOCATE SERVICES ON SITE WAS CARRIED OUT BY FIND THE PIPES - 08/17/23. REFER TO INVESTIGATION REPORT FOR MORE DETAILS.

CONNECT Ø150 UPVC 1100 MIN. DISCHARGE PIPE INTO THE NEW JUNCTION PIT. THE JUNCTION PIT TO BE BUILT OVER THE EXISTING Ø225 COUNCIL DRAIN TO COUNCIL SATISFACTION

EXISTING SEWER TO BE CONFIRMED

Ø225 COUNCIL DRAIN, APPROX. 800 DEEP TO OVERLIFT

STORM RATING NOTE - THE RAINWATER TANK CAPACITY FOR UNIT 2 TO BE INCREASED TO 600L TO ALLOW FOR DETENTION STORAGE OF 2000L WITHIN THE TANKS. REFER TO RAINWATER TANK SECTION DETAIL.

CONSTRUCTED PLANS MUST BE COUNCIL APPROVED DRAWINGS

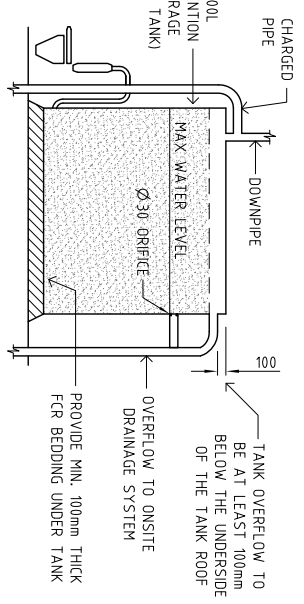

- 3000L THINTANK DETAIL**
- TANKS TO BE CONNECTED IN SERIES.
 - TOTAL COMBINED DETENTION STORAGE TO BE 2000L.
 - ALL PLUMBING FOR TOILET FLUSHING SHALL CONFORM TO AS/NZS 3500

GENERAL DRAINAGE NOTES:

GENERAL:

ALL WORK AND MATERIAL SHALL CONFORM TO THE RELEVANT STANDARD CODES, THE BUILDING CODE OF AUSTRALIA AND THE REQUIREMENTS OF THE LOCAL COUNCIL. CONTRACTOR MUST VERIFY ALL SERVICES, LEVELS AND DIMENSIONS PRIOR TO COMMENCEMENT OF CONSTRUCTION. CONNECTION TO LOCAL COUNCIL PIT/DRAIN TO BE INSPECTED BY THE COUNCILS STATUTORY INSPECTOR GIVING 48 HOURS MINIMUM NOTICE. REINSTATE ALL FOOTPATHS, KERBS, NATURE STRIPS AND CROSSOVERS TO THE REQUIREMENTS OF THE LOCAL COUNCIL

FEATURES & LEVELS:

FOR EXISTING FEATURES, LEVELS AND BENCH MARKS REFER TO SITE PLAN PREPARED BY ARCHITECTS

- STORMWATER LAYOUT**
- dp - DOWN PIPE
 - gt - GRATED TRENCH
 - 150mm WIDE x 225 DEEP (MIN)
 - Ø100 UPVC PIPE
 - Ø100 UPVC CHARGED PIPE
 - Ø100 AGI PIPE
 - 350 x 350 HD PLASTIC PIT

- 100mm CONCRETE DRIVEWAY**
- SL72 MESH TOP, Fc = 25 MPa. PROVIDE CLASS 2 COMPACTED CRUSHED ROCK TO 95% DRY DENSITY
 - 50mm MIN. DRIVEWAY SHALL BE V-SHAPED.

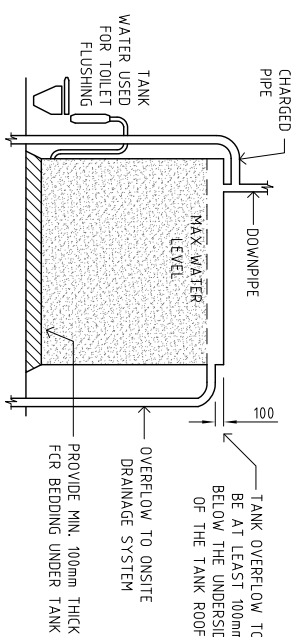

- 3000L POLYMASTER DETAIL**
- ALL PLUMBING FOR TOILET FLUSHING SHALL CONFORM TO AS/NZS 3500

Melbourne Water Storm Rating Report

166225
BAYSIDE
BAYSIDE
32 Kendall Street
Hampton VIC 3188

Assessor: efficiency energy choices
Development Type: Residential - Medium
Alignment Size (m2): 581.00
Storm Rating %: 103

Description	Impervious Area (m2)	Treatment Type	Treatment Area (m2 or L)	Occupancy / Bedrooms	Treatment %	Tank Water Retention (%)
roof 1	144.00	Rainwater Tank	3,000.00	5	133.80	86.20
roof 2	132.00	Rainwater Tank	4,000.00	5	151.00	87.60
driveway 1	37.00	None	0.00	0	0.00	0.00
driveway 2	40.00	None	0.00	0	0.00	0.00
patting 1	14.00	None	0.00	0	0.00	0.00
patting 2	13.00	None	0.00	0	0.00	0.00

REV.	DATE	BY	DESCRIPTION
A	30/01/2024	SC	ISSUE FOR COUNCIL APPROVAL



1318 PLENTY ROAD, BUNDOORA 3083
ACN: 076 152 577
TEL: (03) 9466 7127 MOBILE: 0413 990 167
www.dagroup.com.au
dragand@dagroup.com.au

PROJECT ADDRESS	PROJECT No	REVISION	DESIGNED BY
No.32 KENDALL STREET, HAMPTON	22310702	A	SC
PROJECT DESCRIPTION	DRAWING No	SCALE	
PROPOSED DUAL OCCUPANCY	C1	1:200	
DRAWING DESCRIPTION	SHEET No	DRAWING SIZE	
STORMWATER LAYOUT	1 OF 2	A3	

