

Kitchen Unit 1

Ⓐ.

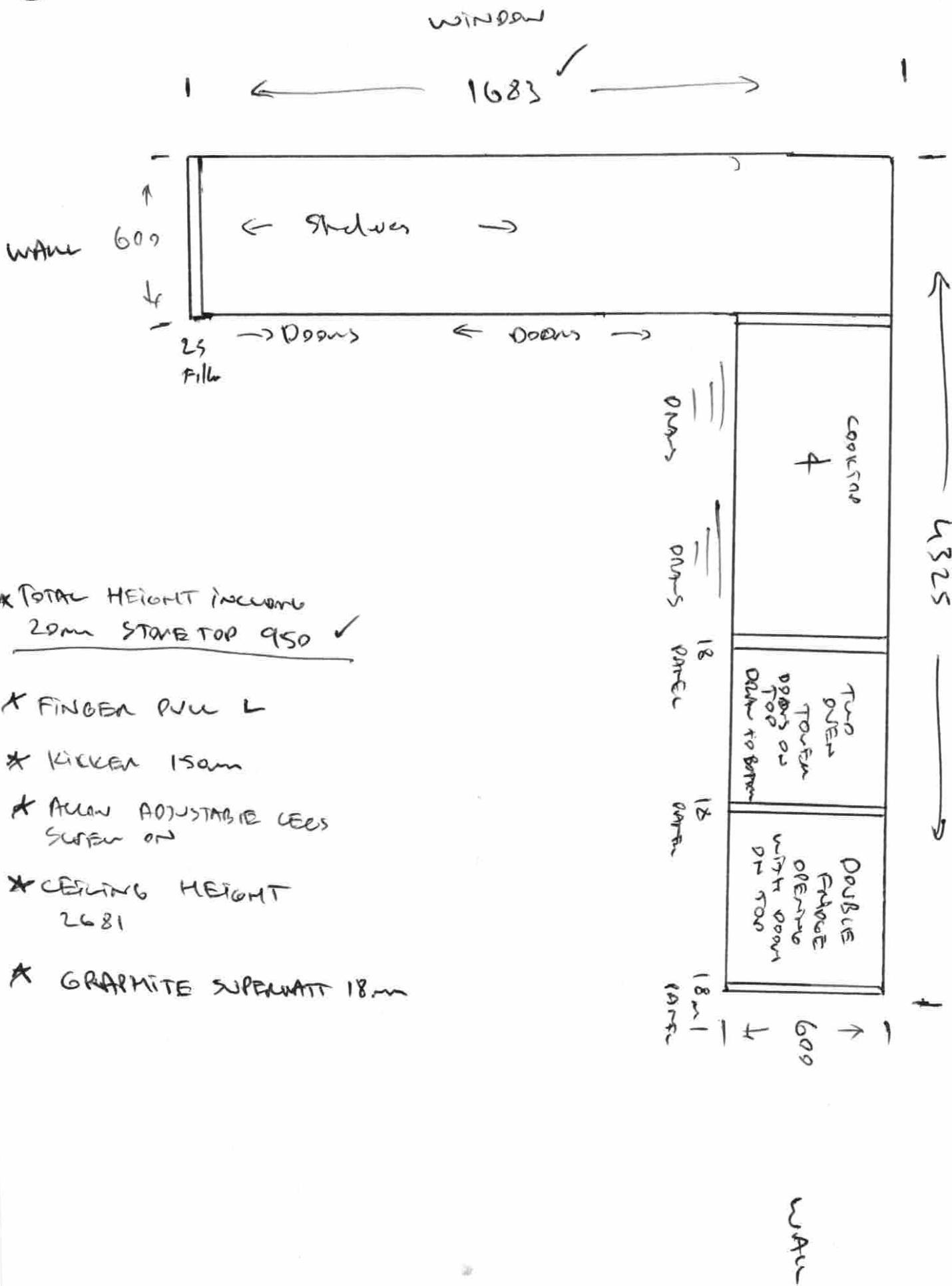

* TOTAL HEIGHT including 20mm STONE TOP 950 ✓

* FINGER PULL L

* KICKER 150mm

* ALLOW ADJUSTABLE LEGS SUPER ON

* CEILING HEIGHT 2681

* GRAPHITE SUPERWATT 18mm

Kitchen Unit ①

OVERHEAD CABINETS.

②

Window

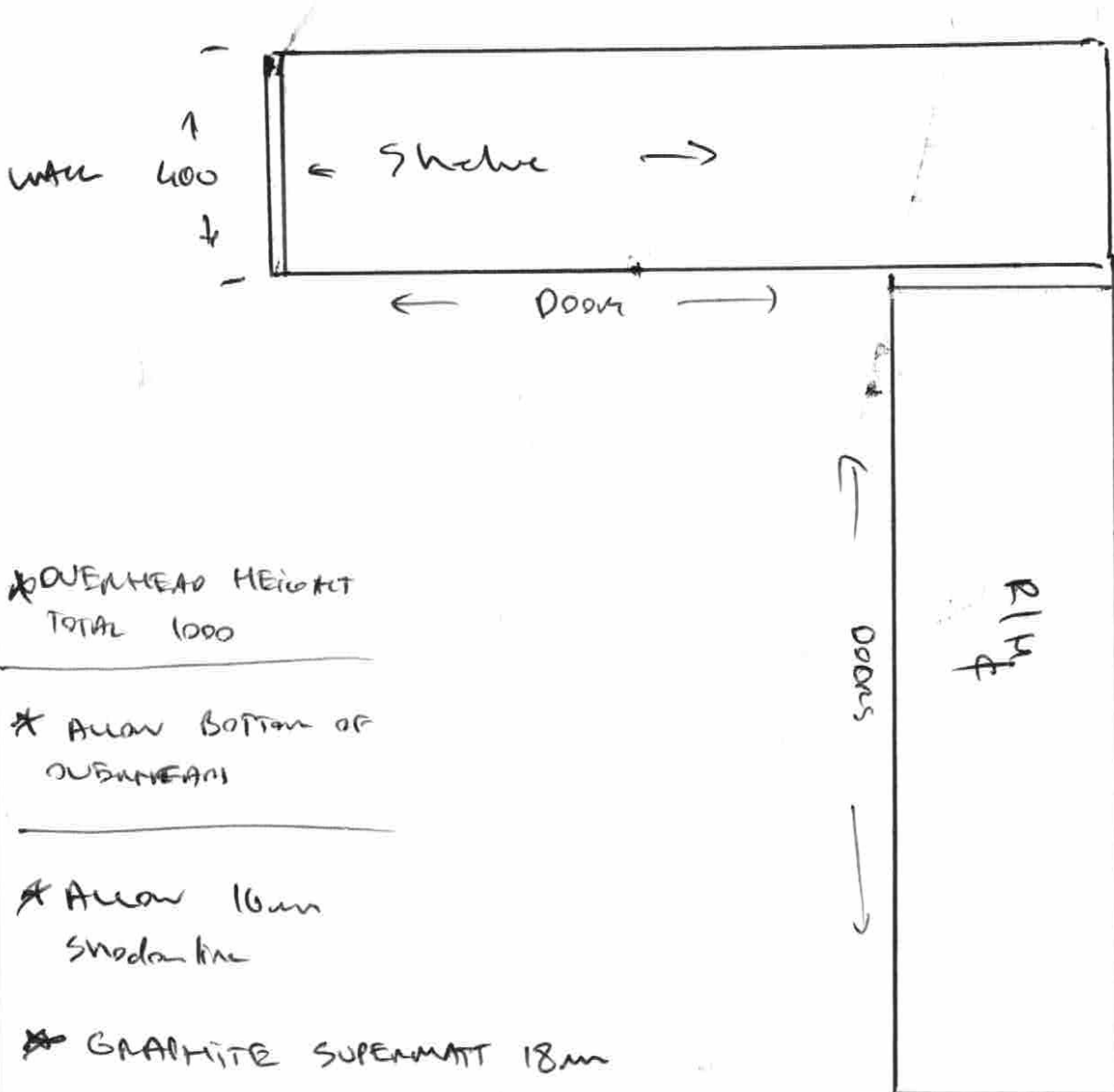

* OVERHEAD HEIGHT TOTAL 1000

* Allow bottom of OVERHEADS

* Allow 16mm shadow line

* GRAPHITE SUPERMATT 18m

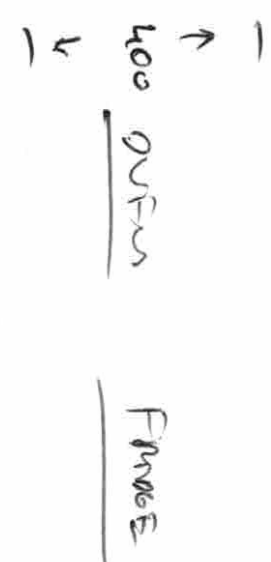

WALK IN PANTRY UNIT 1



Ceiling Height
2692

WINDOW.

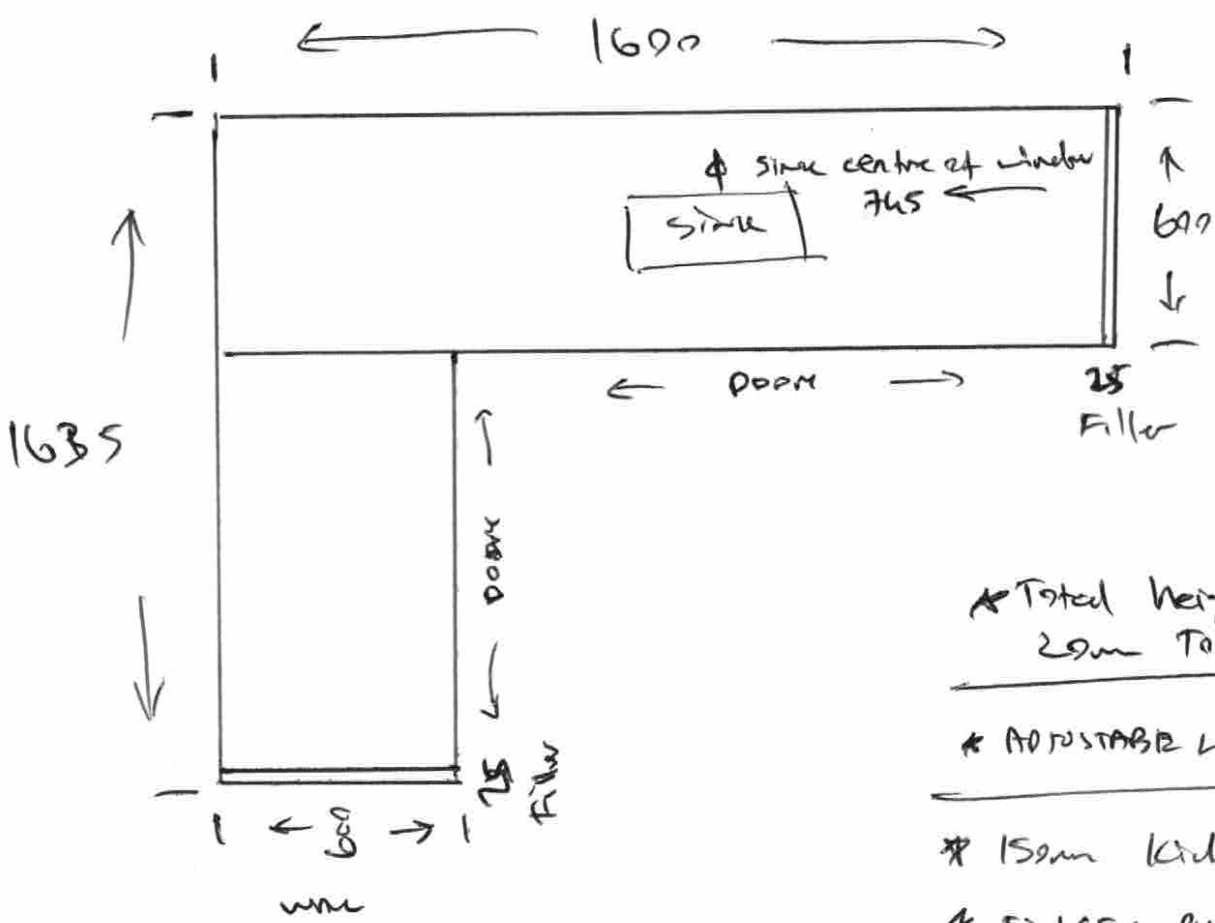

* Total height including
20mm Top 955

* ADJUSTABLE LEGS SCREWS

* 15mm Kickers.

* FINGER PULL L

* GRAPHITE 18mm

* TOTAL HEIGHT.
1040

OVERHEAD CABINET

WINDOW

- * ALUM BITTAN OF OVERHEAD.
- * 16mm Sheldalure
- * GRAPHITE 18mm

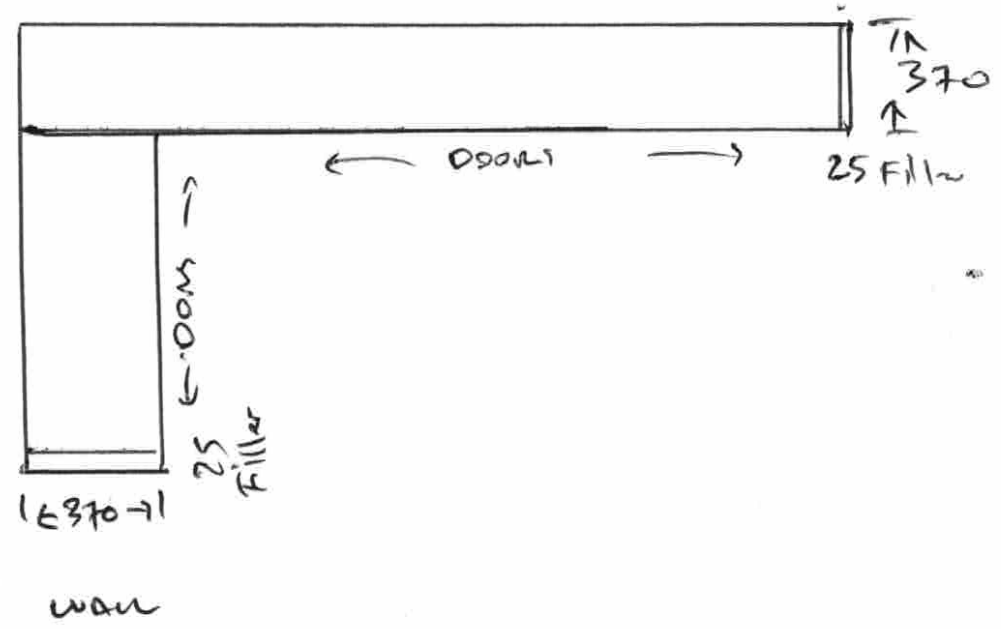

WALL

WALL

TU UNIT

UNIT ①

ⓔ

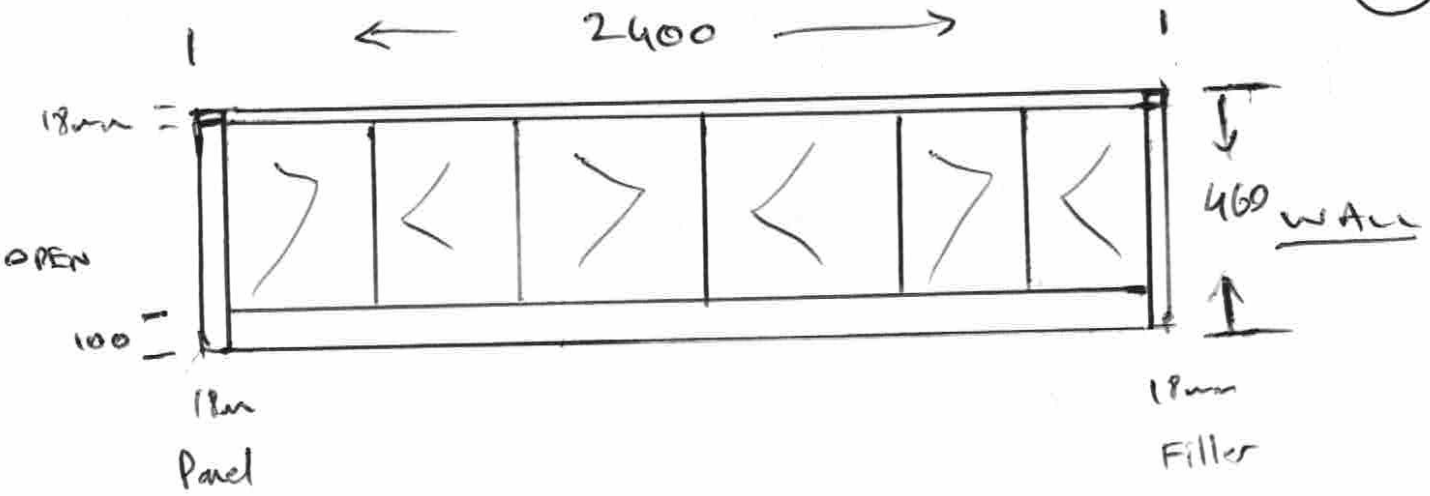

DEPTH 378

* Finger Pull L

Colour

BLACK SUPERMATT 18mm.