

 CONNECT KITCHENS	Client: FARSIDE CONSTRUCTIONS		Door and panels style/colour: POLYTEC NAVY/FRIDGE WHITE SATIN		Sheet 1 of 6
	Room: KITCHEN	Benchtop Colour: MARELLA QUARTZITE	Drawer slides: BLUM ANTARO		Carcass: WHITE HMR/ BLACK EDGE
	Date: 05/06/25	Address: 114 PALMERSTON ST CARLTON	Handles Item No: TBA		Approved by:

ISLAND FRONT

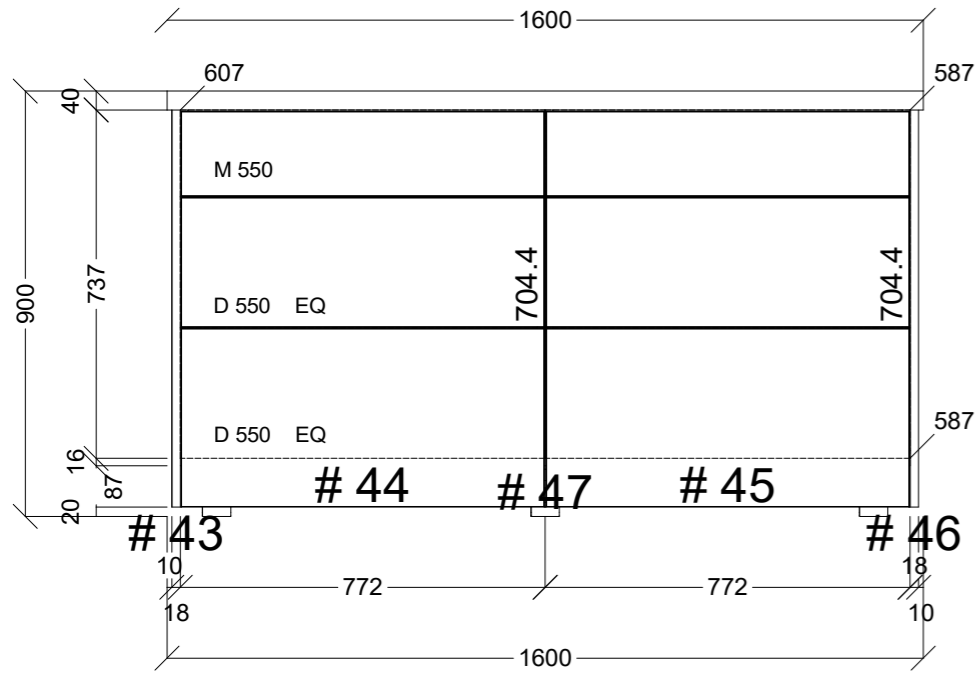

ISLAND REAR

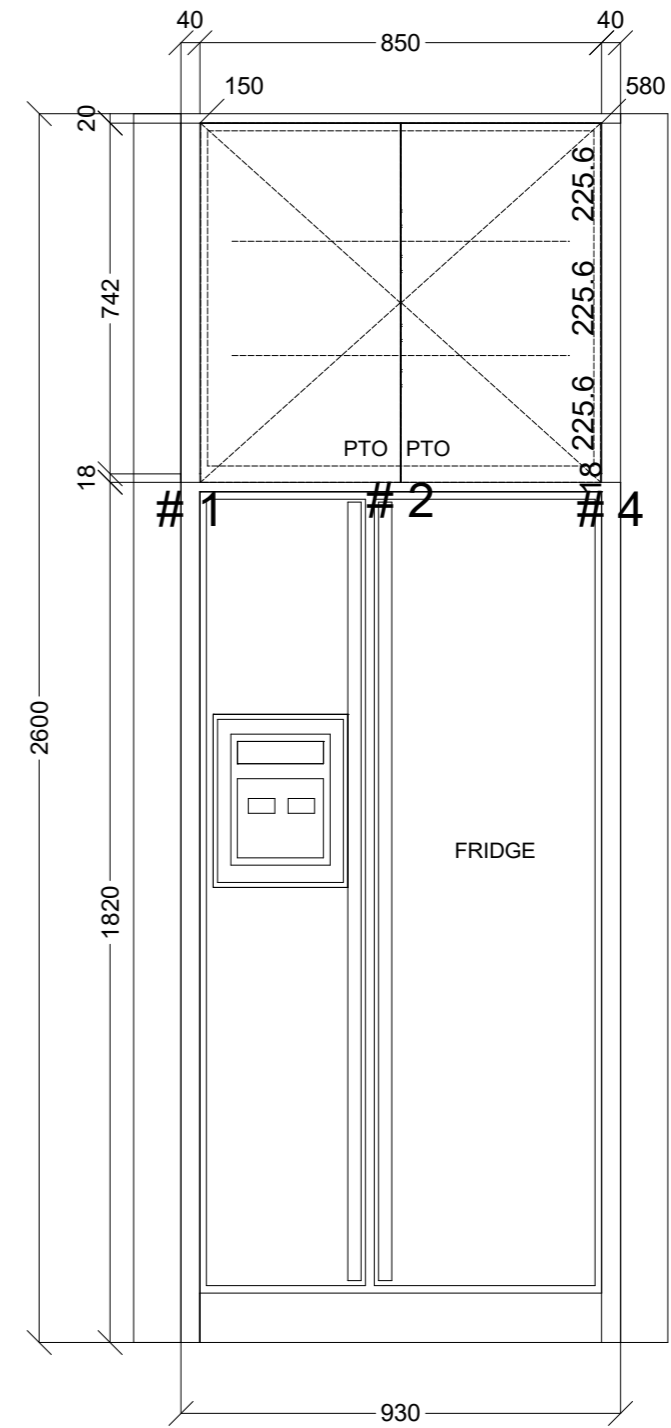
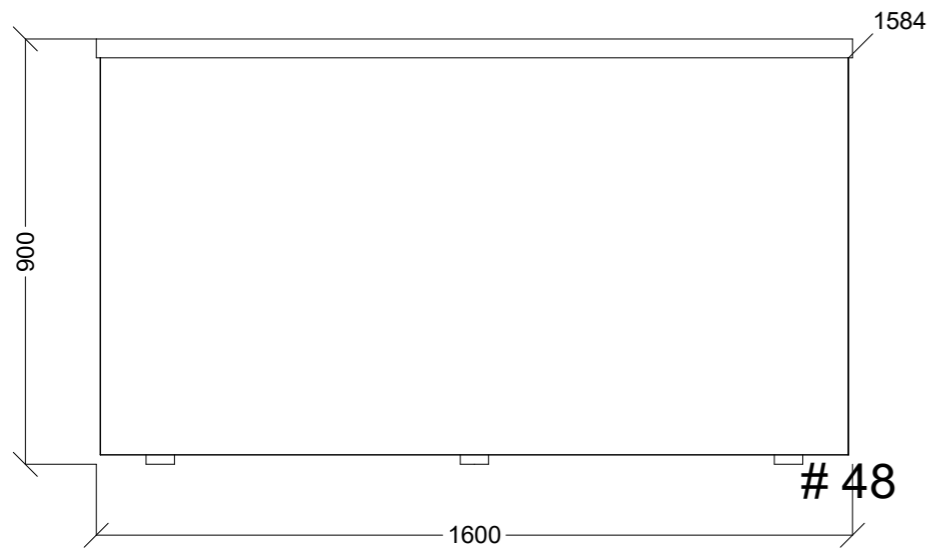

 CONNECT KITCHENS	Client: FARSIDE CONSTRUCTIONS		Door and panels style/colour: POLYTEC NAVY/FRIDGE WHITE SATIN		Sheet 2 of 6
	Room: KITCHEN	Benchtop Colour: MARELLA QUARTZITE		Drawer slides: BLUM ANTARO	Carcass: WHITE HMR/ BLACK EDGE
	Date: 05/06/25	Address: 114 PALMERSTON ST CARLTON		Handles Item No: TBA	Approved by:



	Client: FARMSIDE CONSTRUCTIONS		Door and panels style/colour: POLYTEC NAVY/FRIDGE WHITE SATIN		Sheet 4 of 6
	Room: KITCHEN	Benchtop Colour: MARELLA QUARTZITE		Drawer slides: BLUM ANTARO	Carcass: WHITE HMR/ BLACK EDGE
	Date: 05/06/25	Address: 114 PALMERSTON ST CARLTON		Handles Item No: TBA	Approved by:

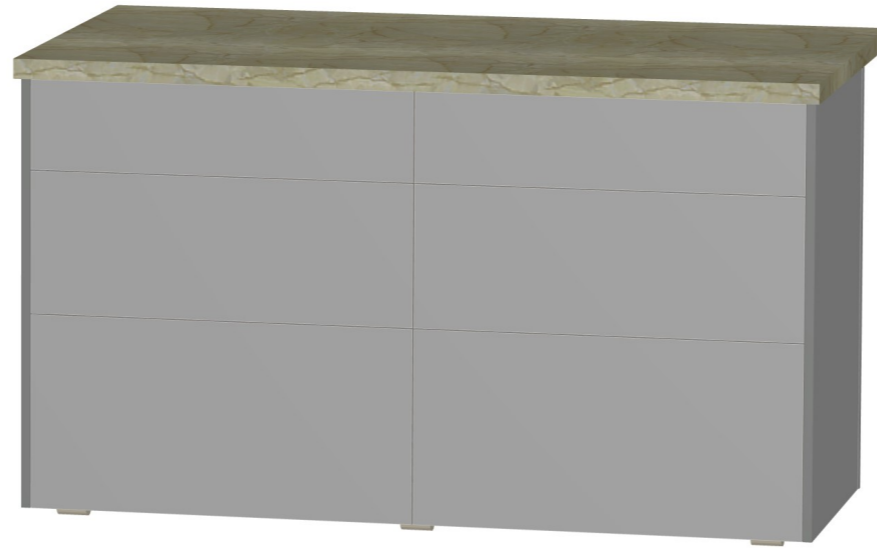

	Client: FARSSIDE CONSTRUCTIONS		Door and panels style/colour: POLYTEC NAVY/FRIDGE WHITE SATIN		Sheet 5 of 6
	Room: KITCHEN	Benchtop Colour: MARELLA QUARTZITE		Drawer slides: BLUM ANTARO	Carcass: WHITE HMR/ BLACK EDGE
	Date: 05/06/25	Address: 114 PALMERSTON ST CARLTON	Handles Item No: TBA		Approved by:

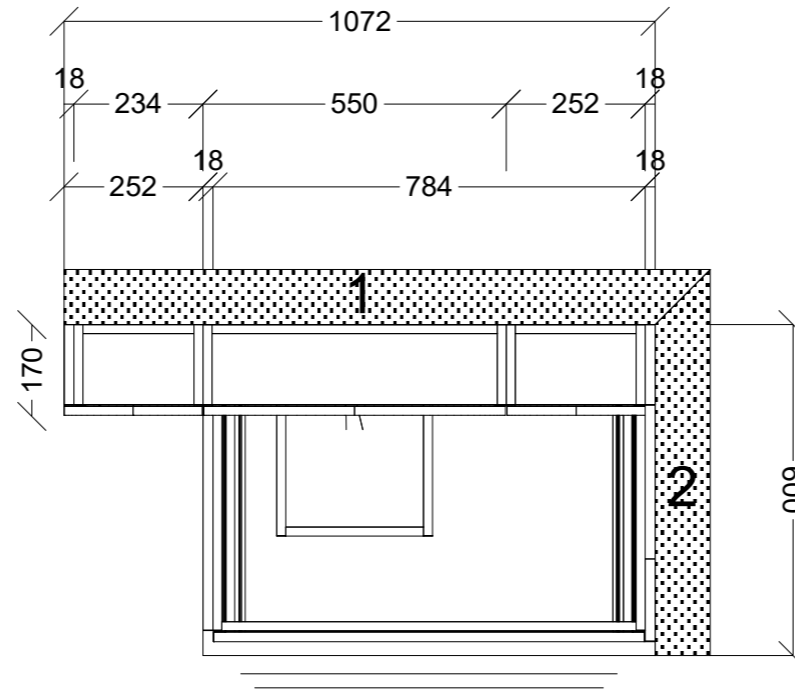
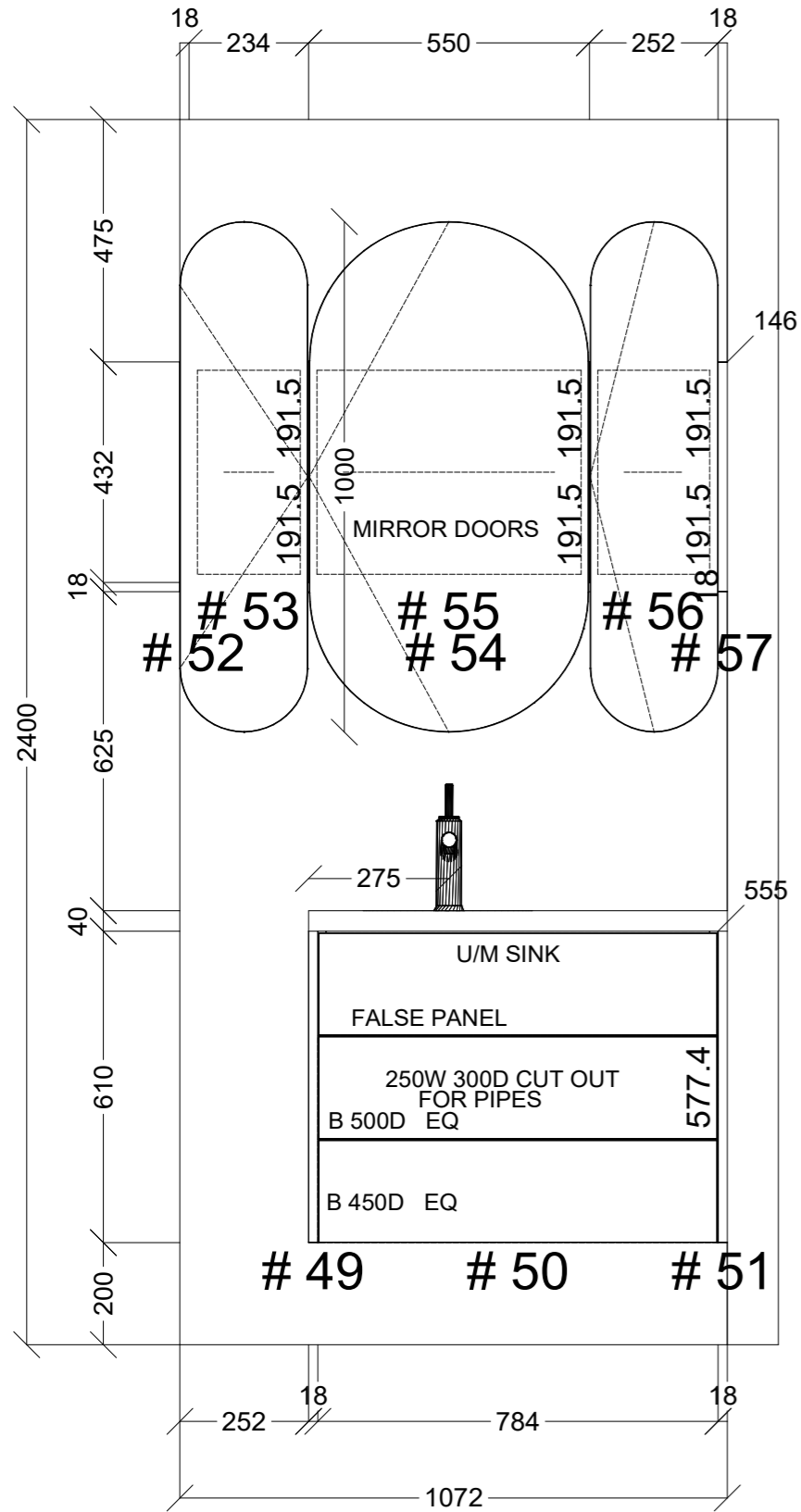

 CONNECT KITCHENS	Client: FARSIDE CONSTRUCTIONS		Door and panels style/colour: POLYTEC NAVY		Sheet 6 of 6
	Room: BATHROOM		Benchtop Colour: MARELLA QUARTZITE		Drawer slides: BLUM ANTARO
	Carcass: WHITE HMR/ BLACK EDGE		Date: 05/06/25		Address: 114 PALMERSTON ST CARLTON
Approved by:					